



SHERON

RESIDENCE
of HERITAGE

I PHILLOSOPHY

II HERITAGE

III CULTURAL DIALOGUE

IV VILLAS

V THE ART OF GARDEN

VI SHERON PARK

VII GUZAR

VIII PRIVACY



PHI

*Some places are
shaped by necessity,
while others are born
of meaning.*

ILO

Sheron Residence
is built upon the idea
of preservation
and creation.

SO

It stands as
an architectural
vision — a seamless
continuation of
a living cultural code.

PHY



*F*or centuries, our land has stood as a crossroads of civilizations, where culture, spirituality, and the region's Islamic heritage thrived. Cities emerged here as hubs of craftsmanship, learning, and commerce.

We are guided by this heritage not as a relic of the past, but as a living source of enduring principles: continuity, harmony, and timeless resilience.

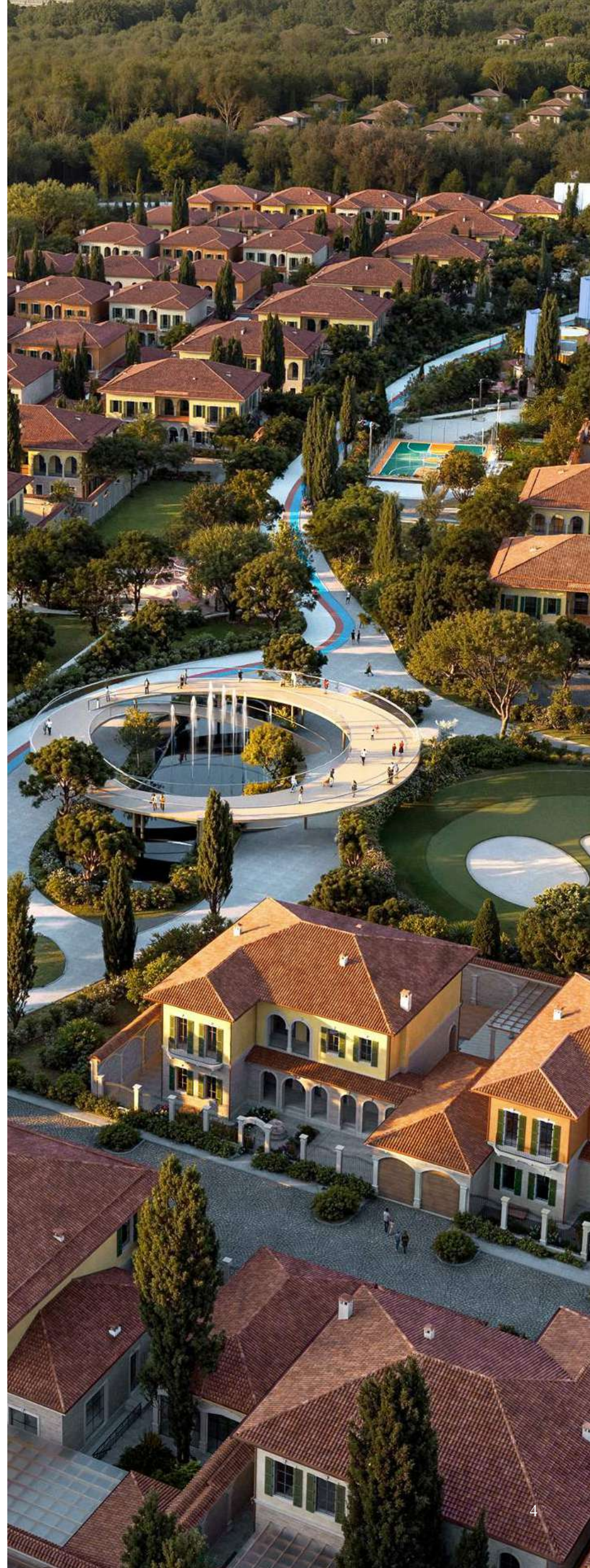



SHERON RESIDENCE
EMBODIES A NEW
CULTURE OF LIVING.

Here, the home becomes an environment that shapes identity, because true sustainability begins with deep cultural roots.





*At Sheron Residence,
contemporary comfort is
combined with respect for the
past and a sense of responsibility
for the future, creating a place
where your family's legacy
is born.*





THE NAME OF THE
SHERON RESIDENCE PROJECT –
“BOG‘I SHERON”
(GARDEN OF LIONS) –
DRAWS INSPIRATION FROM
ONE OF THE GARDENS
CREATED BY AMIR TEMUR

*I*n the philosophy of that era, the lion was revered as the guardian of the home and a symbol of inner strength. At Sheron Residence, this timeless legacy is reimagined on a new scale: the lion safeguards not merely the boundaries of a home, but an entire living ecosystem thoughtfully designed for its residents.





DIALOGUE

O

The conceptual foundation of Sheron Residence unites two distinct cultural codes – Uzbekistan and Italy.

At the heart of this dialogue lies a shared vision of greatness: just as the Timurid legacy elevated garden art into the highest form of state aesthetics, the Florentine Renaissance transformed villas into a symbol of harmony between human and nature.

QUE





The thread that unites this legacy is the dialogue between two symbols: the lion of Eastern architectural tradition, a timeless symbol of home and protection, and the Florentine Lion of Marzocco, guardian of order and dignity in Italy.





VILLA L.A. S

The origins of villas trace back to Ancient Rome, where they stood as an architectural vision of the art of solitude – retreats for patricians from the city’s bustle. For centuries, this form of residence has symbolized both prestige and the aspiration to live in harmony with nature.



The villas at Sheron Residence reflect the heritage of Italian architecture: a solid, rusticated base pays homage to Florentine palazzos, while the elegant upper sections glow in warm shades of terracotta, lemon, and white sand.

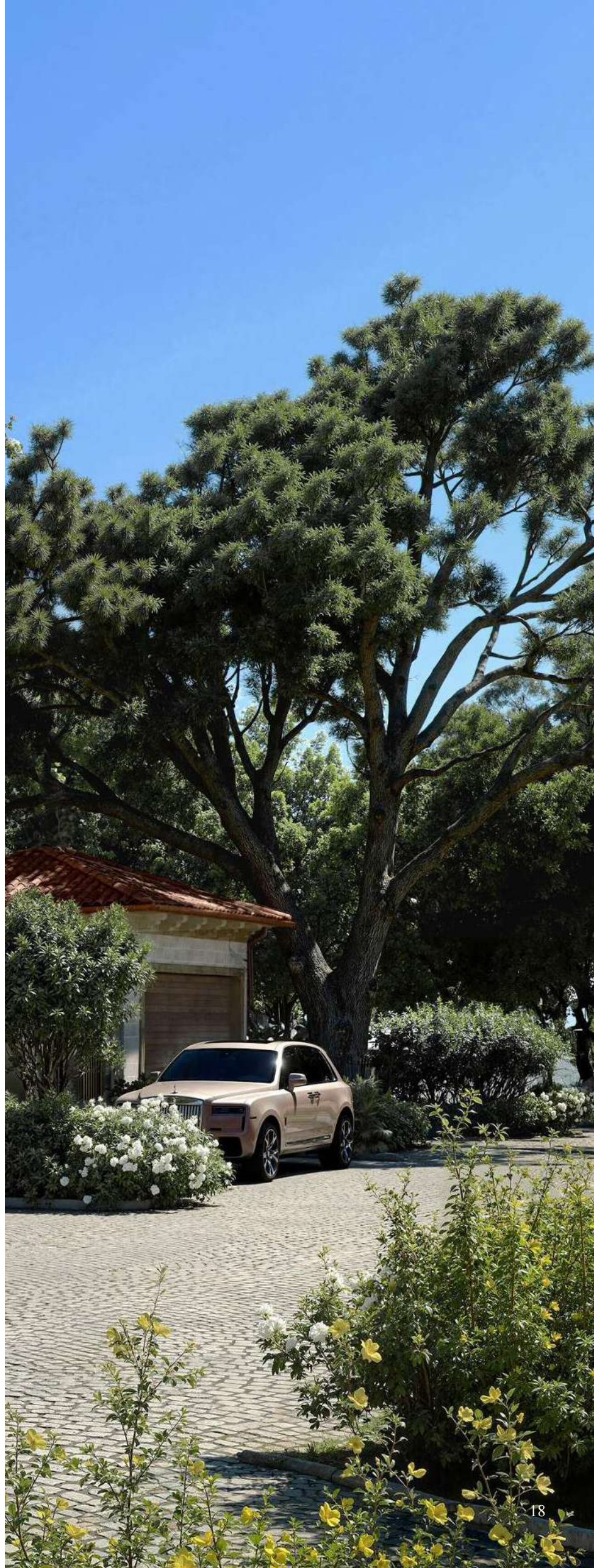



THE VILLA GROUNDS
FLOW ORGANICALLY
INTO THE SURROUNDING
LANDSCAPE.

*A*t the main entrance, a lush courtyard with a fountain serves as a graceful extension of the architecture, while the rear terrace hosts a pool and a summer kitchen, creating private space for rest.





THREE FACETS OF PERFECTION

The architectural vision of Sheron Residence unfolds across three plot sizes – 600, 900, and 1,200 m². Regardless of the plot dimensions, each villa preserves perfectly balanced proportions and complete independence within the estate.







VERTICAL COMFORT



The villas are designed around a functional vertical concept. The lower, basement level serves as a sanctuary for personal relaxation and recreation, featuring a hammam, fitness area, and home cinema. The first and second floors are thoughtfully arranged for the comfort of a large family, offering formal living rooms, studies, and master suites with private access.













SPATIAL HARMONY

Soaring ceilings and panoramic glass seamlessly merge the interior with the garden, transforming your home into a natural extension of the park. The spacious, thoughtfully designed rooms offer both comfort and functionality, shaping a refined new standard of everyday living.









GOUL TU RE

The Timurid period gave the world a unique concept of the “garden city.” A special place in the history of this art is held by the record of the Spanish ambassador Rui González de Clavijo, who visited Samarkand in the 15th century.

EXQUISITE DESCRIPTIONS
OF PARK ENSEMBLES
INTRODUCED ENLIGHTENED
EUROPE TO THE
EXTRAORDINARY
SCALE OF EASTERN
LANDSCAPE DESIGN.

*T*hrough the writings of Rui González de Clavijo, the Western world discovered the garden as a supreme expression of order, where disciplined geometry and living nature fused into a single, perfect organism.





*A*t Sheron Residence, we breathe new life into this grand tradition, reinterpreting it through the modern philosophy of the “free garden.” In our climate, shade and water are not mere decorative elements – they are the principal architects of comfort. We craft not just landscaping, but an entire ecosystem for reflection. Here, the gentle murmur of water and the rustling of leaves become natural therapy, restoring the inner rhythm lost in the bustle of city life.

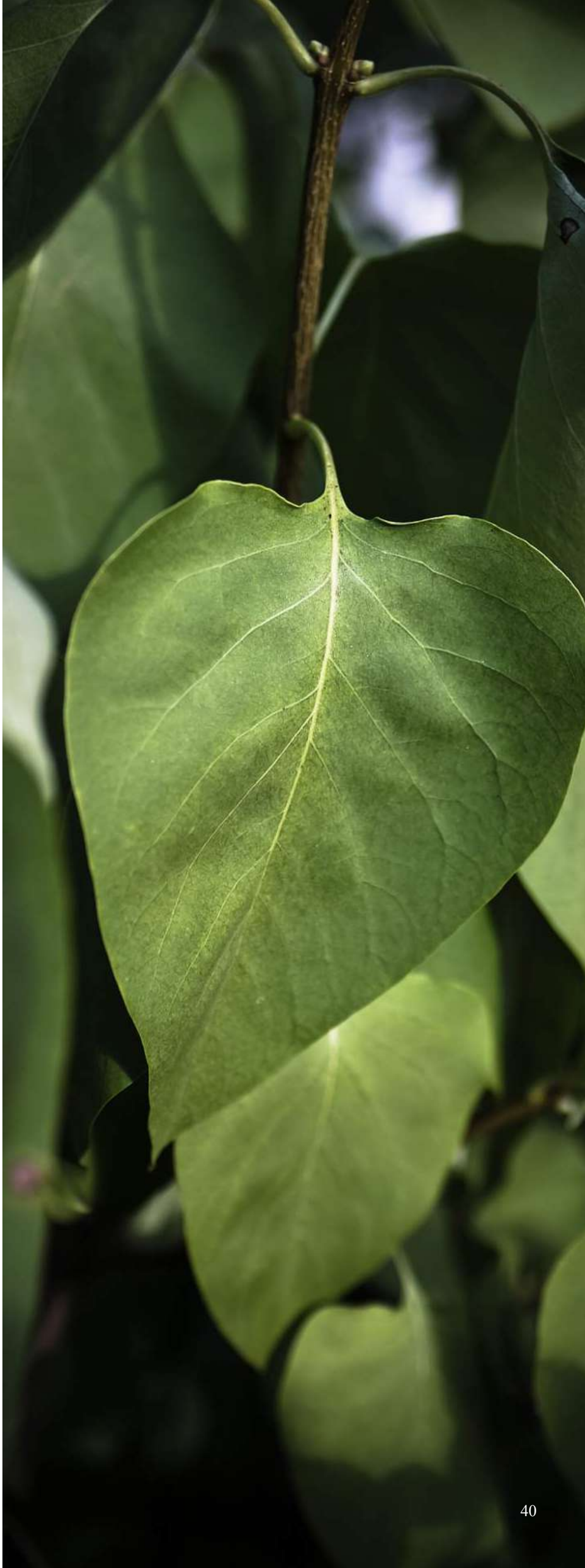



PAA

ARK

A five-hectare
oasis of living
nature in the heart
of the residence.



SYMBOLISM OF ELEMENTS

Every detail in the landscape of Sheron Residence is purposeful and designed to resonate with both the senses and deeper meaning.

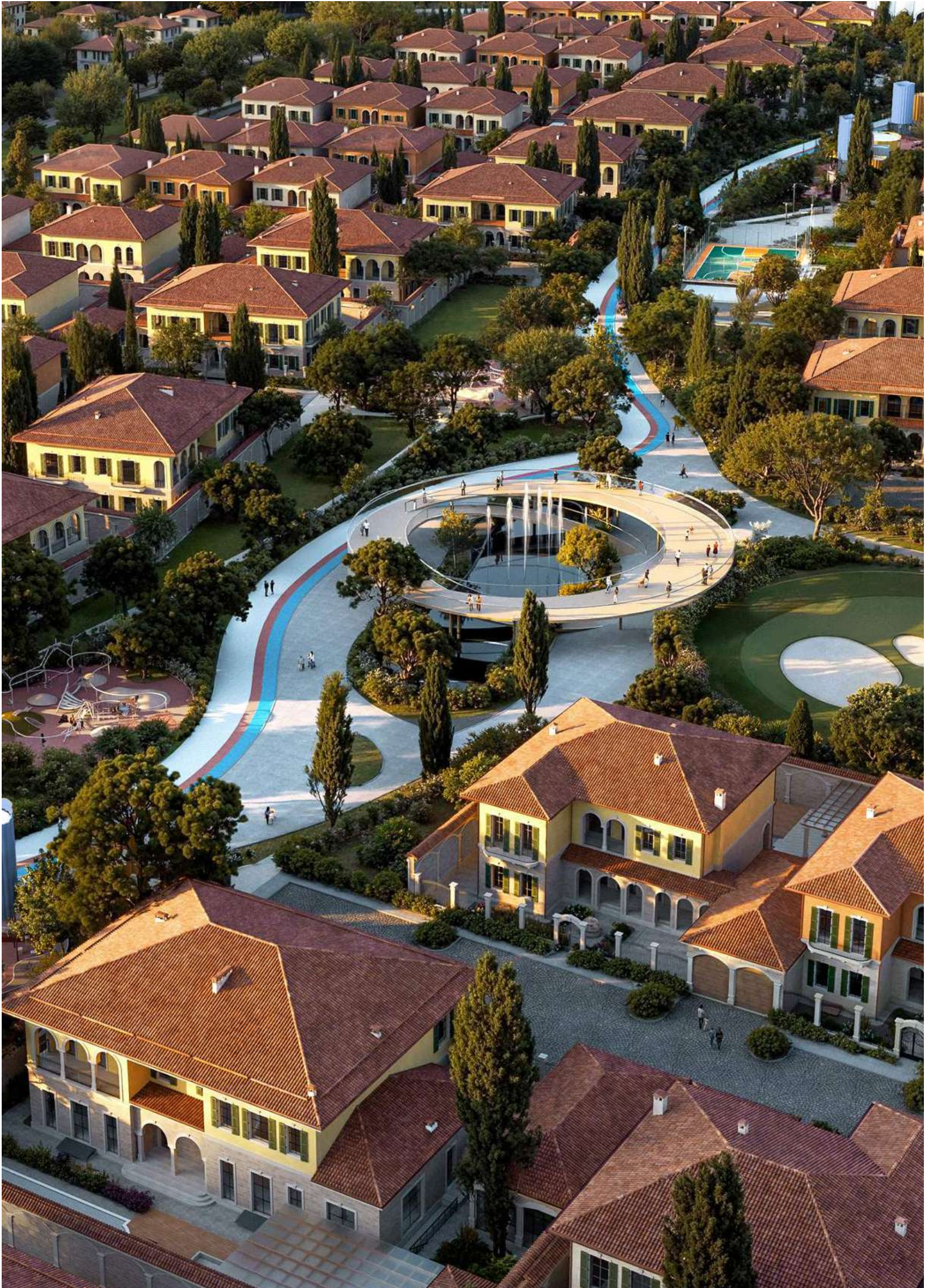



WATER ELEMENTS

*F*ountains

at Sheron Residence stand as symbols of life's constant flow and renewal. Seamlessly woven into the landscape of each villa and the central park, they form a cohesive aesthetic and climatic harmony.





SHADE ARCHITECTURE

The gazebos and park pavilions at Sheron Residence are crafted as all-season leisure spaces. Offering shelter from sun and rain, they let residents savor the outdoors at any hour, in complete comfort.

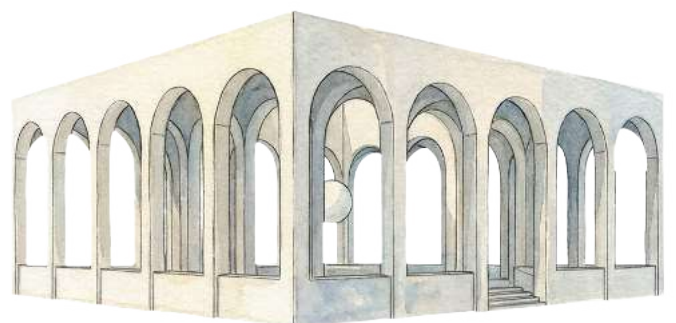





HERITAGE OF GARDENS

*T*rees throughout the park embody the link between generations. Spring blossoms and autumn harvests echo the cycles of time, celebrating the resilience and continuity of family traditions.









TERRITORY OF DISCOVERY

*P*laygrounds are made from eco-friendly materials and integrated into the natural terrain, stimulating imagination and active development. Specialized mother-and-child rooms in the park allow families to enjoy the outdoors, at their own pace.

SPORTS ETIQUETTE

*S*heron Residence sports venues offer a private, club-like setting, integrated into the park landscape. Carefully selected disciplines reflect and cultivate the refined lifestyle of our residents.







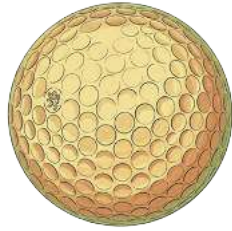

GOLF

*S*pecialized golf zone offers residents the opportunity to refine their skills without leaving the residence.







TENNIS COURT

The project includes a professional court – the perfect setting for morning matches, where every detail of the infrastructure meets the standards of elite sports clubs.







SPORTS ARENA

A multi-purpose venue with professional flooring, easily adapted for football, volleyball, or basketball.

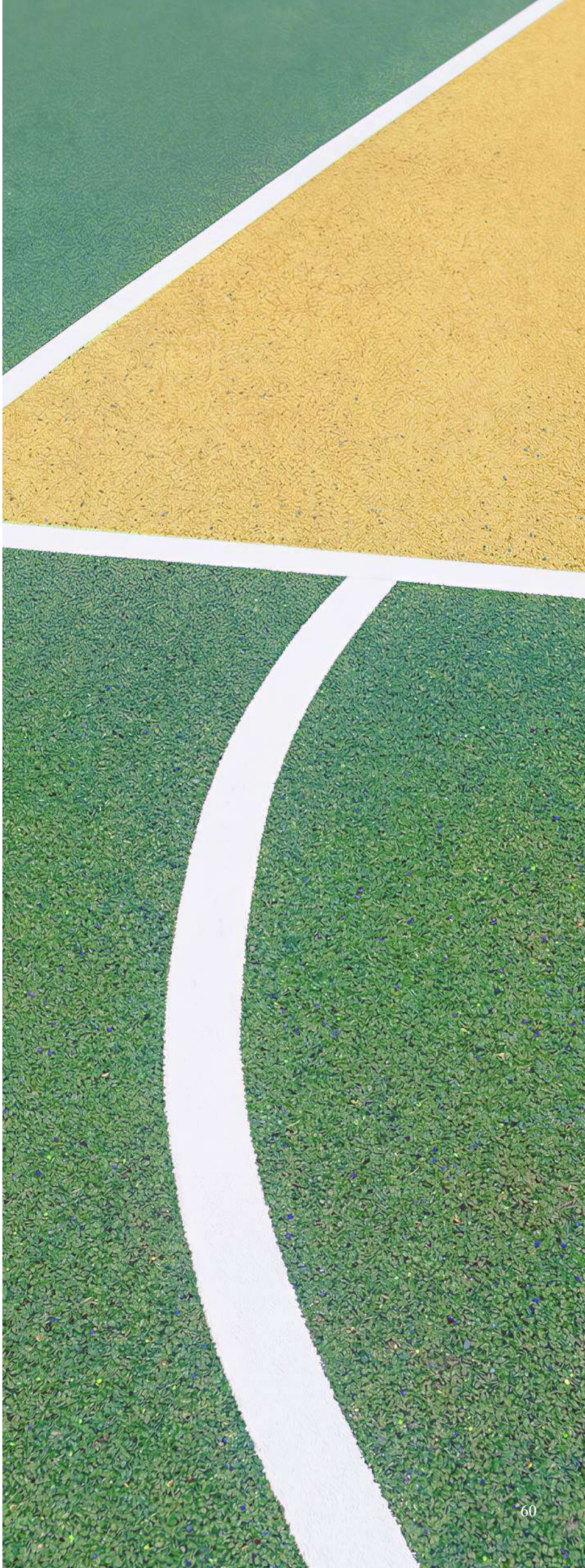



G U

Z A

R

*G*uzar reimagines the traditional community center for contemporary living. Within a single space, it brings together a banquet hall, tea house, open-plan office, and open-air terrace.



*The building
facades feature
deep relief.
This play
of light and
shadow evokes
a modern
reinterpretation
of relief
architecture,
refined
to perfection
by Renaissance
masters.*





Guzar fosters a sense of belonging at Sheron Residence, transforming neighborly connections into an organic continuation of everyday life.





PRIVACY

Entry to Sheron Residence is marked by a signature architectural gateway, embodying both exclusivity and the grandeur of the estate.





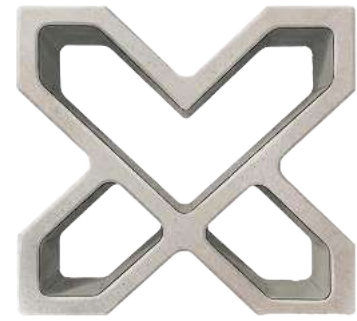

The main decorative feature is the Girih, a geometric ornament symbolizing Central Asian architecture and Tashkent craftsmanship. A glass block panel within captures and diffuses natural light, bathing the lobby in a gentle glow.

Here, historic tradition meets contemporary service, heralding a space where every detail is devoted to your comfort.



EPIC LOG UE

*Residence of
Heritage*
is a dialogue of eras,
cultures, and
generations.

It is an environment
where heritage
is not just preserved
in memory, but
continues to live.

